

# SEC 180-4

Circular Breaking Saw  
Electric

Product Brochure

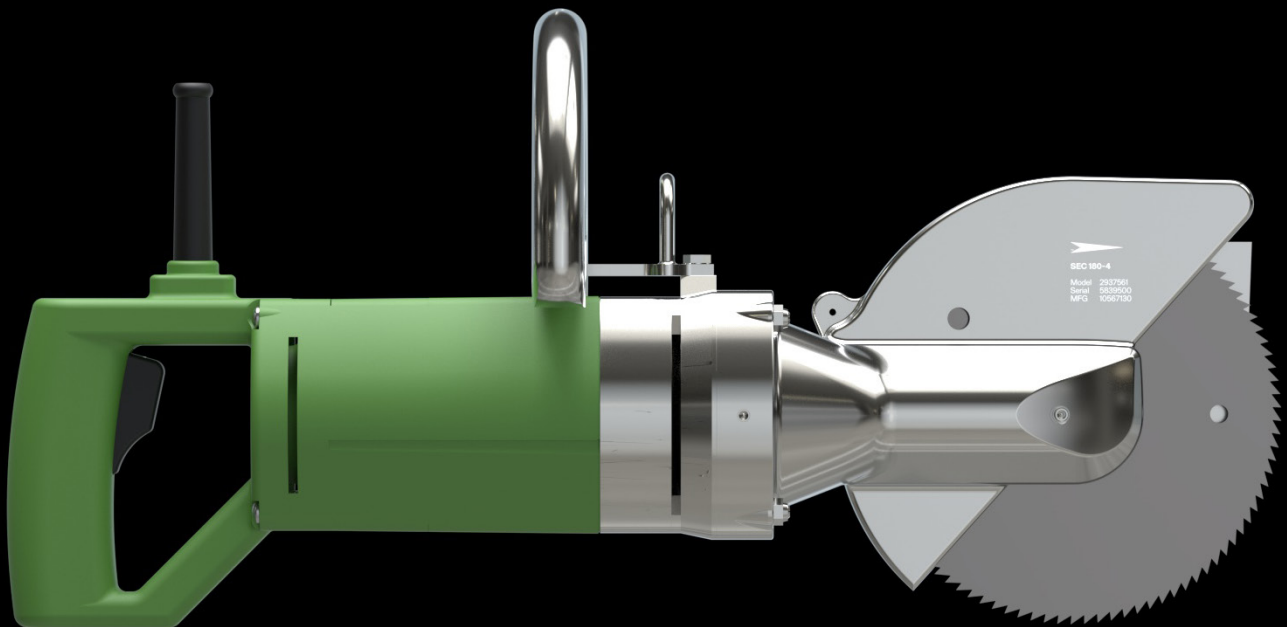

JARVIS®

Jarvis Products Corporation  
33 Anderson Road  
Middletown, CT 06457  
United States of America

[www.jarvisproducts.com](http://www.jarvisproducts.com)  
[sales@jarvisproducts.com](mailto:sales@jarvisproducts.com)  
T 860-347-7271  
F 860-347-6978

# SEC 180-4

Circular Breaking Saw  
Electric

Product Brochure

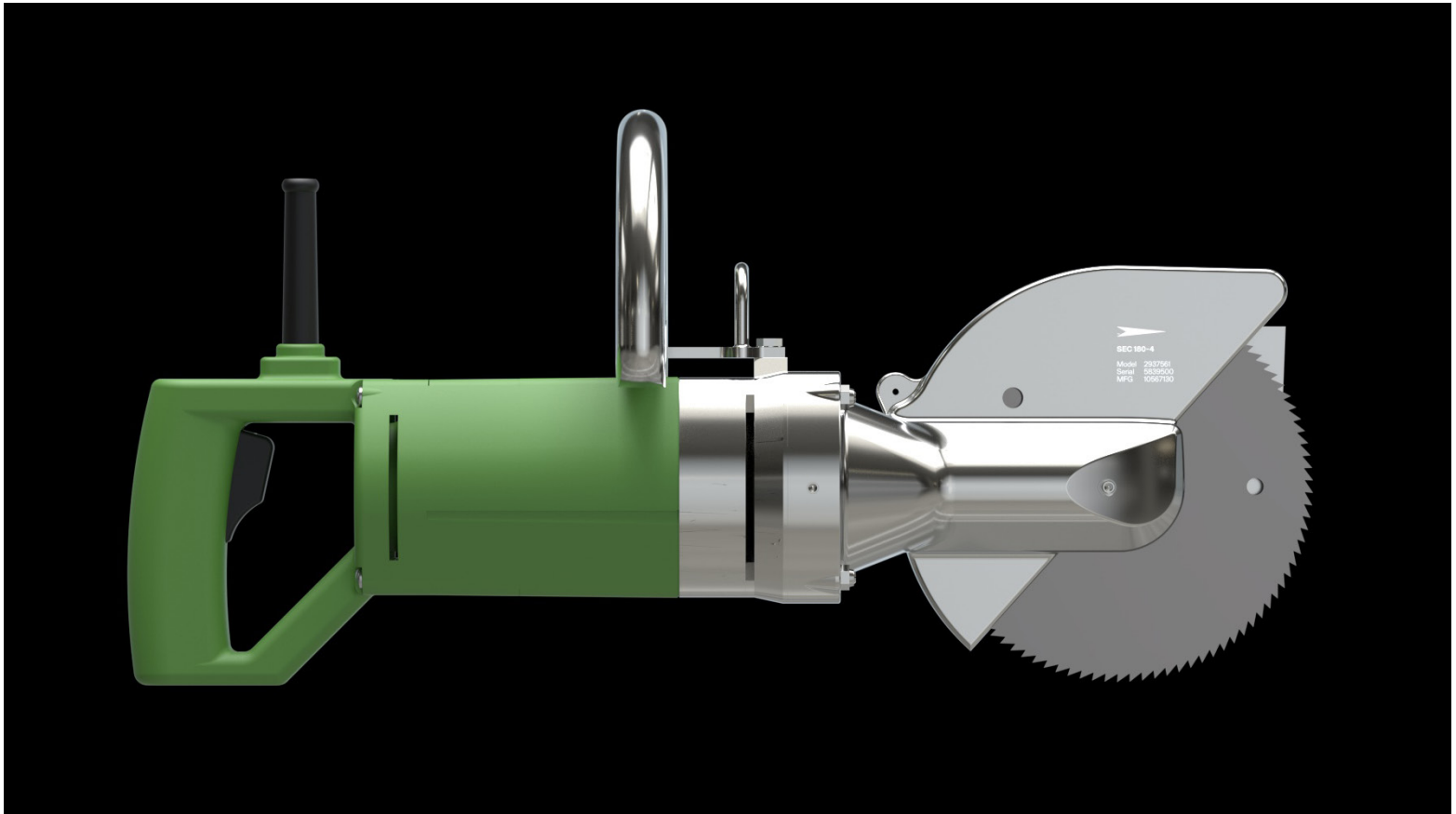
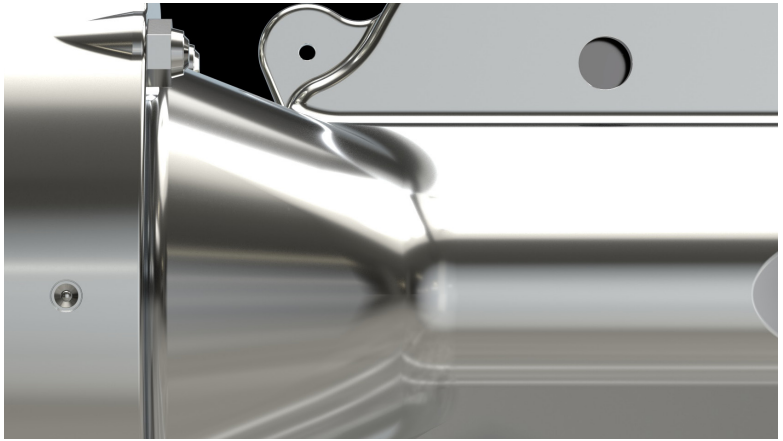

JARVIS®

Jarvis Products Corporation  
33 Anderson Road  
Middletown, CT 06457  
United States of America

[www.jarvisproducts.com](http://www.jarvisproducts.com)  
[sales@jarvisproducts.com](mailto:sales@jarvisproducts.com)  
T 860-347-7271  
F 860-347-6978

## Descriptions

- The SEC 180-4 applications include: pork ribbing, ham marking, shoulder marking, and removing contaminated back bones.
- Double insulated electric motor for electrical safety.
- Lightweight and flexible - suitable for rail or table.
- Blade brake.
- Adjustable to 66 mm (2.6 in) maximum depth of cut.
- Meets national and international requirements for hygiene and safety.

## Specifications

### SEC 180-4

Drive			Electric
Motor Power	1400 W		1.9 hp
Operating Voltage		230 / 115 V, 1 phase, 50 / 60 Hz	
Full Load Amps	6.5A @ 230V		13A @ 115V
Blade Speed			1650 rpm
Brake			Mechanical
Control Handles	Single Trigger / Dual Handles		Electric
Blade Diameter	180 mm		7.1 in
Cutting Depth	66 mm		2.6 in
Overall Length	546 mm		21.5 in
Weight	6.6 kg		14.6 lbs
Vibration (front and rear handles)	Rear	0.8 m / sec <sup>2</sup>	118.0 dB
	Front	2.95 m / sec <sup>2</sup>	129.4 dB
Noise (one meter from tool)			96 dB

## Equipment Selection and Accessories

### SEC 180-4

	Order Number
115 V, 1 phase, 50 / 60 Hz, Adjustable Depth Gage	4004354
115 V, 1 phase, 50 / 60 Hz, Indexing Depth Gage	4004357
230V, 1 phase, 50 / 60 Hz, Adjustable Depth Gage	4004355
230 V, 1 phase, 50 / 60 Hz, Indexing Depth Gage	4004358
Blades	7180 mm / 7.1 in diameter - 98 teeth
	7180 mm / 7.1 in diameter - 48 teeth
Tool Kit	8039382
Optional Torque Wrench	8039381
Balancer	4042040